



Move-In Checklist

Necessary Items	Suggested items	Items to Leave at Home
<input type="checkbox"/> Bath robe, shower shoes <input type="checkbox"/> Shower Caddy <input type="checkbox"/> Towels and Washcloths <input type="checkbox"/> Twin-Sized Bedding (Comforter, sheets, pillowcases, blankets, etc. - NO outside mattresses) <input type="checkbox"/> Alarm Clock <input type="checkbox"/> Power Strips/ 3-Prong Adaptors <input type="checkbox"/> Outdoor Approved Extension Cord <input type="checkbox"/> Laundry Items (Detergent, Laundry Hamper, quarters for the machines, etc.) <input type="checkbox"/> Emergency Kit (First Aid Kit, Batteries, Bottled Water, Flashlight, etc.) <input type="checkbox"/> Paper Towels/Kleenex <input type="checkbox"/> Clothes Hangers <input type="checkbox"/> Room decorations, pictures of family and friends	<input type="checkbox"/> Dorm-Size Refrigerator <input type="checkbox"/> Small Microwave <input type="checkbox"/> Throw Rug or Carpet Samples <input type="checkbox"/> TV/DVD/Stereo (Your room has an outlet for FREE cable TV) <input type="checkbox"/> Game System (PS4, Xbox, Wii, etc.) <input type="checkbox"/> Laptop <input type="checkbox"/> Fan <input type="checkbox"/> Curtains <input type="checkbox"/> Crates or Stacking Containers <input type="checkbox"/> Lamps <input type="checkbox"/> Mirror with Over-Door Hooks <input type="checkbox"/> Plates, Mugs, Silverware, etc. <input type="checkbox"/> Bike <input type="checkbox"/> School Supplies <input type="checkbox"/> Basic Cleaning Supplies	<input type="checkbox"/> Candles/Incense <input type="checkbox"/> Hot Plates, Slot Toasters, or Other Fire Hazards <input type="checkbox"/> Halogen Lamps <input type="checkbox"/> Outside furniture <input type="checkbox"/> Alcohol <input type="checkbox"/> Weapons (Including air pellet, soft pellet, water, paintball, or BB guns, swords, knives, etc.)
		Miscellaneous
		<input type="checkbox"/> _____ <input type="checkbox"/> _____ <input type="checkbox"/> _____ <input type="checkbox"/> _____ <input type="checkbox"/> _____ <input type="checkbox"/> _____ <input type="checkbox"/> _____ <input type="checkbox"/> _____

Housing Reminders

- Complete the Residence Hall Application. Be sure that all of the information you provide is accurate.
- Complete all other required paperwork with administrative offices.
- *Move-in Day:* You will receive a room key & fill out a **required paperwork** at your assigned residence hall.
- **Remember:** Every effort will be made to accommodate each student's residential needs. There are some instances where a student will be allowed to change dorm rooms pending approval of the Hall Resident Director/Director of Student Affairs. Failure to follow proper check-out procedures will result in fees on the student's account. Fees for damage to dorm rooms and/or to residence hall bathrooms, hallways, lobby, etc. will be placed on the student's account when necessary. In cases where no one admits to having caused damage or we cannot find the personal responsible on the security cameras, a fine/fee will be divided amongst all of the residents in the hall.

Hopefully, this general list will give you an idea of what you will need to set up your home here at Hiwassee. If you have any further questions, please let us know. We're always available to answer any questions or concerns you might have. We're looking forward to having you here at HC!

Tom Black & Allison Halls

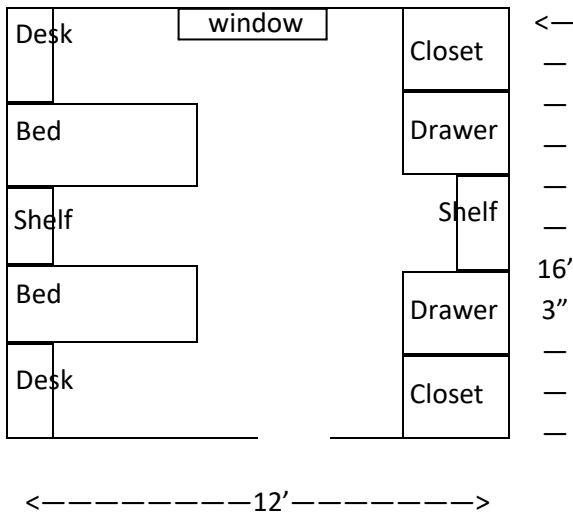

Window is 48" wide, 50.5" long

Brock Hall

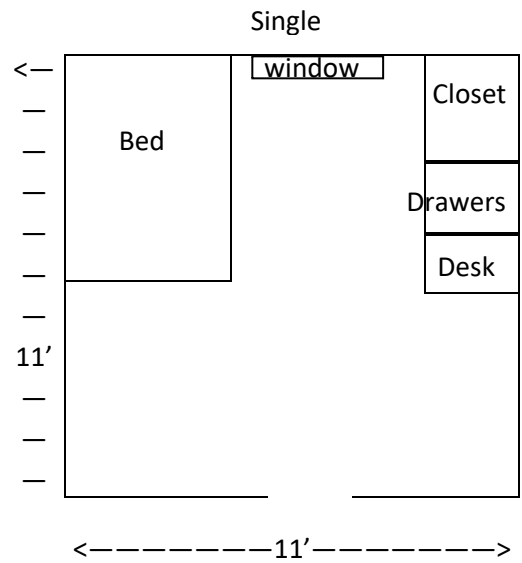
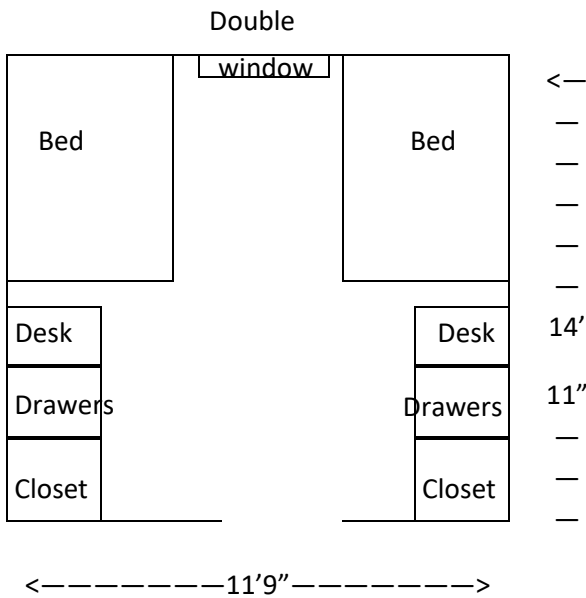

Window is 50.5" wide, 54" long.